



25th Avenue Grade Separation Staff Introduction and Update

TA Board of Directors
Item #11 (b) – May 6, 2021



Presentation Overview

- Project and Program Oversight
- Project Location and Benefits
- Staffing
- Schedule and Risks
- Costs
- Construction update
- Coordination with City of San Mateo



Project and Program Oversight

- Retooling reporting to enhance communication and transparency
- Rebuilding and strengthening Caltrain project delivery
- Recent additions
 - ✓ Deputy Chief, Rail Development: Rob Barnard
 - ✓ Director, Capital Program Delivery: Andy Robbins
 - ✓ Director, Capital Program Management: Jonathan Tillman
- Role of the Transportation Authority in Caltrain project oversight



Project Location



Project Benefits

- East West Access
- Economic Development
- Roadway/Railroad Safety
- Benefit of Completing Project Pre-Electrification



Project Staffing

- Strengthening the project team
- Added Senior Construction Manager, *Andy Kleiber* to facilitate bringing the project over the finish line
- Actively managing project completion within revised budget



Project Schedule

- Project advanced from 85% complete in January to 90% today
- Major milestone – Hillsdale Station opened **4/26/21!**
- Road work progressing with phased completions
 - New 28th Ave opened **3/2/21**
 - 25th Ave under construction – opening scheduled for **August**
 - 31st Ave under construction – opening scheduled for **August**
- Project completion Date: **September 2021 with a celebratory ceremony**



Remaining Risks

- Still digging at 25th and 31st
 - Unknown utility conflict risk
 - Utilities impacting work at 25th
 - Unknown ground condition risk
 - Encountering soft soil in 31st Ave
 - Encountering buried concrete in 25th Ave
- Covid-19 Impacts
- Subcontractor escalation costs from project delays



Project Cost Summary

Description	Post Bid (2017)	Estimate at Completion
Pre-Construction Costs	\$14.7	\$15.0
Construction Costs	\$82.9	\$115.0
Transferred scope to CSM		\$0.5
Parking Track	\$2.0	\$4.1
Right of Way & Utilities	\$12.0	\$32.1
Construction Management	\$28.6	\$38.4
Contingency	\$39.8	\$2.5
PCEP Reimbursable	\$0.00	(\$1.8)
Total	\$180.0	\$205.9

- Additional Funding = \$25.9M



Project Update (Photos)



Hillsdale Station Open for Service 4/26/21

Project Update (Photos)



Hillsdale Station Open for Service 4/26/21

Project Update (Photos)



Hillsdale Station Open for Service 4/26/21



Project Update (Photos)



28th Ave



28th Ave

Project Update (Photos)



25th Ave

Project Update (Photos)



31st Ave



31st Ave

City of San Mateo Coordination

- Utility relocation resulted in a need to move a City storm drain to Delaware Street
- Work was done as part of 25th Ave Project
 - Substantial completion inspection 3/26/21



City of San Mateo Coordination

- City of San Mateo's Delaware Sewer Relief Project
 - New line located below project's surface improvements
- In public's interest for City of San Mateo to deliver both sewer line **and** 25th Ave project's surface improvements
 - Rather than a negotiated price for the sanitary sewer work, the City will get the benefit of a competitive bid
 - Amending various project agreements as needed



City of San Mateo Coordination

- Delaware Sewer Relief Project

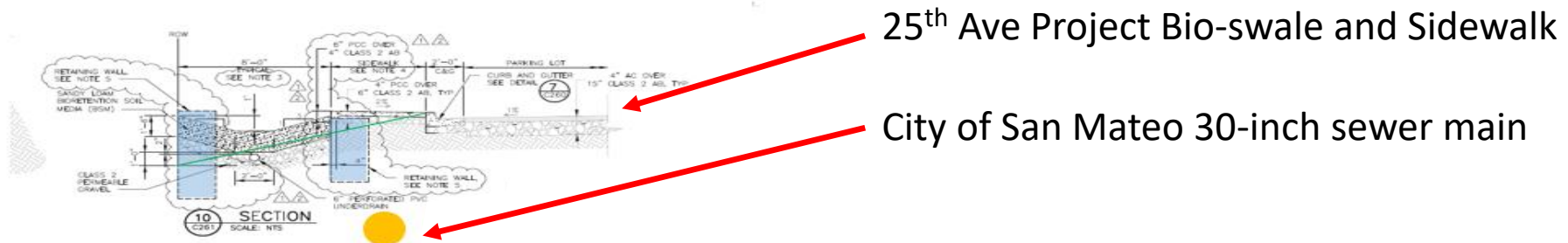
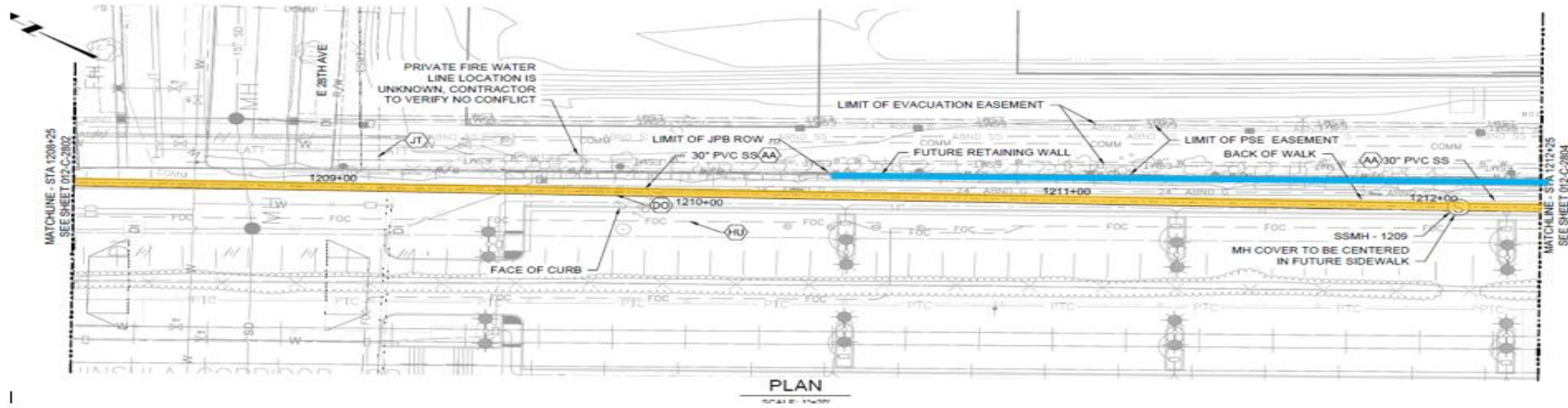

Questions