



25th GS Updates

Citizens Advisory Committee
November 18, 2020
Agenda Item #8

Project Location



25th Ave Completed Work

- Grade Separation is Completed as of July 2020
- MT-1 and MT-2 are in service and fully operation
- Bridge work is completed

25th Ave Ongoing Work

- 28th Ave – Retaining Walls and Roadway Excavation
- 31st Ave – Retaining Walls and Roadway Excavation
- North and South Parking Lots
- Station Platform Work with Amenities and Fixtures

25th Ave Schedule*

- 28th Ave Completion – Dec 2020
- Station Opening – Spring 2021
- 25th Ave will close once 28th Ave is open - Opening in Spring 2021
- 31st Ave Opening (Project Completion) - Fall 2021



* All dates subjected to change dependent on weather constraints and other unknown conditions

28th Ave Ongoing Work



After Completion Rendering– 28th Ave



Ongoing - Parking Lot South of 28th Ave



Ongoing - Parking Lot North of 28th Ave



Ongoing – Hillsdale Station



After Completion Rendering– Station

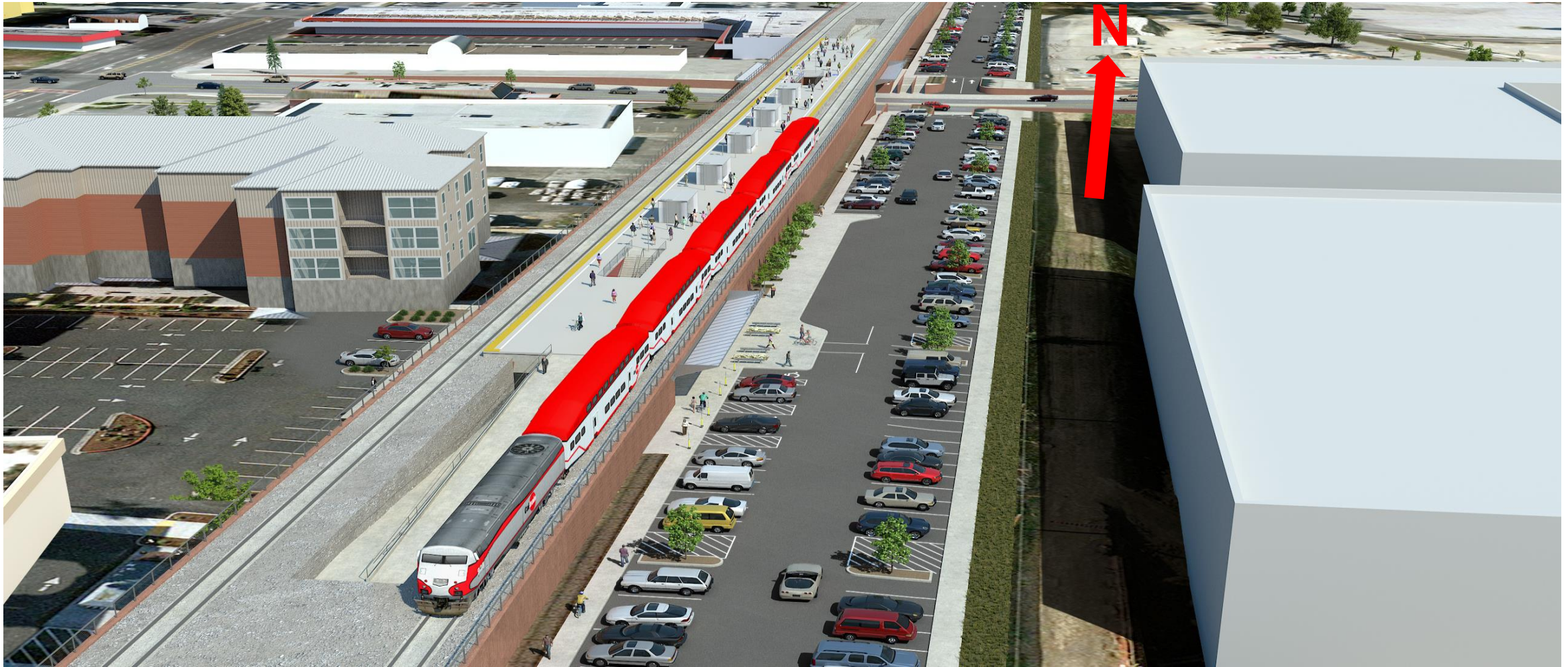

After Completion Rendering– Hillsdale Sta



Ongoing 31st Ave

Looking towards El Camino Real



East Side – of 31st Ave



After Completion Rendering– 31st Ave



Upcoming Work – 25th Ave



After Completion Rendering– 25th Ave



Public Outreach

- Weekly Construction Updates
- Construction Notices
- Project Milestone Updates
- Website and Social Media
- Public Meetings

25th Avenue Grade Separation Project: Upcoming Night Work

Dear Caltrain Neighbor,

As part of the 25th Avenue Grade Separation Project, crews will begin installing temporary shoring at 25th Avenue in the Caltrain right-of-way in mid-February. Sheet piles, used for temporary shoring, are a retention system where steel sheets are installed with a vibratory hammer to create a support wall. In an effort to mitigate the noise, crews will pre-drill prior to inserting the sheets. While the majority of work is conducted during the day, some night work is required due the activity's proximity to the railroad tracks. To start construction earlier in the evening, Caltrain plans to single track its trains when night work is scheduled.

Partial sidewalk and lane closures on E. 25th Avenue (between El Camino Real and S. Delaware) are also occurring as part of the project and will be intermittent for up to four months. All businesses along E. 25th Avenue will remain open during construction. Please note the construction schedule is subject to change. We apologize for any inconvenience the construction may cause.

The 25th Avenue Grade Separation Project will raise the tracks and slightly lower the road (grade separate) at E. 25th Avenue in San Mateo. Caltrain, in cooperation with the City of San Mateo, is implementing the project to improve safety for both motorists and pedestrians. In addition, the project provides an opportunity to complete east-west street connections at 28th and 31st Avenues. The project will reduce local traffic congestion and horn noise, and as part of the project improvements, Caltrain will build a new elevated Hillsdale Station with updated amenities at E. 28th Avenue, allowing for better safety and reduced traffic.

Caltrain offers a weekly notice for those interested in the latest construction activities. To sign-up for the weekly construction notices, please call the Caltrain Customer Service Center at 650.508.7726.

1.31.18

Subscribe

You can now receive Caltrain notifications via e-mail! Find out more [HERE](#)

Highlights

- Weekday Timetable
- Weekend Timetable
- Special Events
- Electrification

Social

Social Media icons for Google+, Twitter, Facebook, Instagram, Tumblr, Pinterest, and YouTube.

The screenshot shows the Caltrain website's 'Projects & Plans' section for the 25th Avenue Grade Separation project. The page features a navigation menu with 'Projects & Plans' selected. A sidebar on the left lists various project categories. The main content area displays the project title and a prominent 'Sign Up for Project Updates' button, which is circled in red. Below the button is an aerial rendering of the completed project, showing the new elevated tracks and street connections. The page also includes a 'Subscribe' section for email notifications and a 'Highlights' section with links to timetables and events.

Contact Information

Website: www.caltrain.com/25thGS

Phone: 1.800.660.4287

Email: SMGradeSep@Caltrain.com

Twitter: @Caltrain, @GoCaltrain

Questions