

CALTRAIN ELECTRIFICATION



BREWSTER CROSSING LANE CLOSURE NOTICE | March, 2022

UPCOMING ACTIVITIES AND LANE CLOSURE

Between March 28 and April 8, Caltrain will be performing potholing work in Redwood City that will require partial closure of the Brewster railroad crossing to vehicle and bicycle traffic. The temporary lane closure is required due to construction equipment and crews entering and exiting the Caltrain right-of-way at Brewster.

Work will take place on March 28 through April 8 22 between 7:30 a.m. to 4 p.m.

Construction signs and illuminated directional signs will direct vehicle traffic from closed lanes to the open lanes.

A lane closure map is provided on the reverse of this notice for vehicle and bicycle traffic.

CONSTRUCTION ACTIVITIES

During the closure crews will be working along the Caltrain corridor to pothole for signal infrastructure for the Caltrain Electrification Project.

Caltrain will work with contractors to limit the impact to surrounding communities. To mitigate noise and other impacts during night activities, the field team will utilize acoustical noise barrier blankets and will position lights away from residential and business areas. Caltrain has established a dedicated project hotline and email for residents concerned about these potential impacts.

PROJECT OVERVIEW

Over the last decade, Caltrain has experienced a substantial increase in ridership and anticipates further increases in ridership demand as the Bay Area's population grows. Caltrain Electrification, scheduled to be operational by 2024, will electrify and upgrade the performance, operating efficiency, capacity, safety, and reliability of Caltrain's commuter rail service.

Caltrain electrification is a key component of the Caltrain Modernization Program and consists of replacing diesel-hauled with an electric train system for services between Fourth and King Street Station in San Francisco and the Tamien Station in San Jose. The project will include the installation of new electrical infrastructure and the purchase of electric trains.

CONTACT INFORMATION

Caltrain has established a project information line and project e-mail for Caltrain Electrification to record and respond to questions and comments from residents and stakeholders.

The project information line can be reached at **650.399.9659** or toll free at **800.660.4287**.

The project e-mail is calmod@caltrain.com

Sign up for weekly construction updates can be found online at: www.calmod.org/get-involved



FOR MORE INFORMATION

 calmod.org

 Para traducción llama al 1.800.660.4287
如需翻譯,請電 1.800.660.4287
Cần dịch thuật, xin gọi 1.800.660.4287

CONTACT

MAIL: 2121 S. El Camino Real, Suite 300
San Mateo, CA 94403

 650.399.9659
 calmod@caltrain.com

Caltrain Electrification Project

BREWSTER LANE CLOSURE MAP

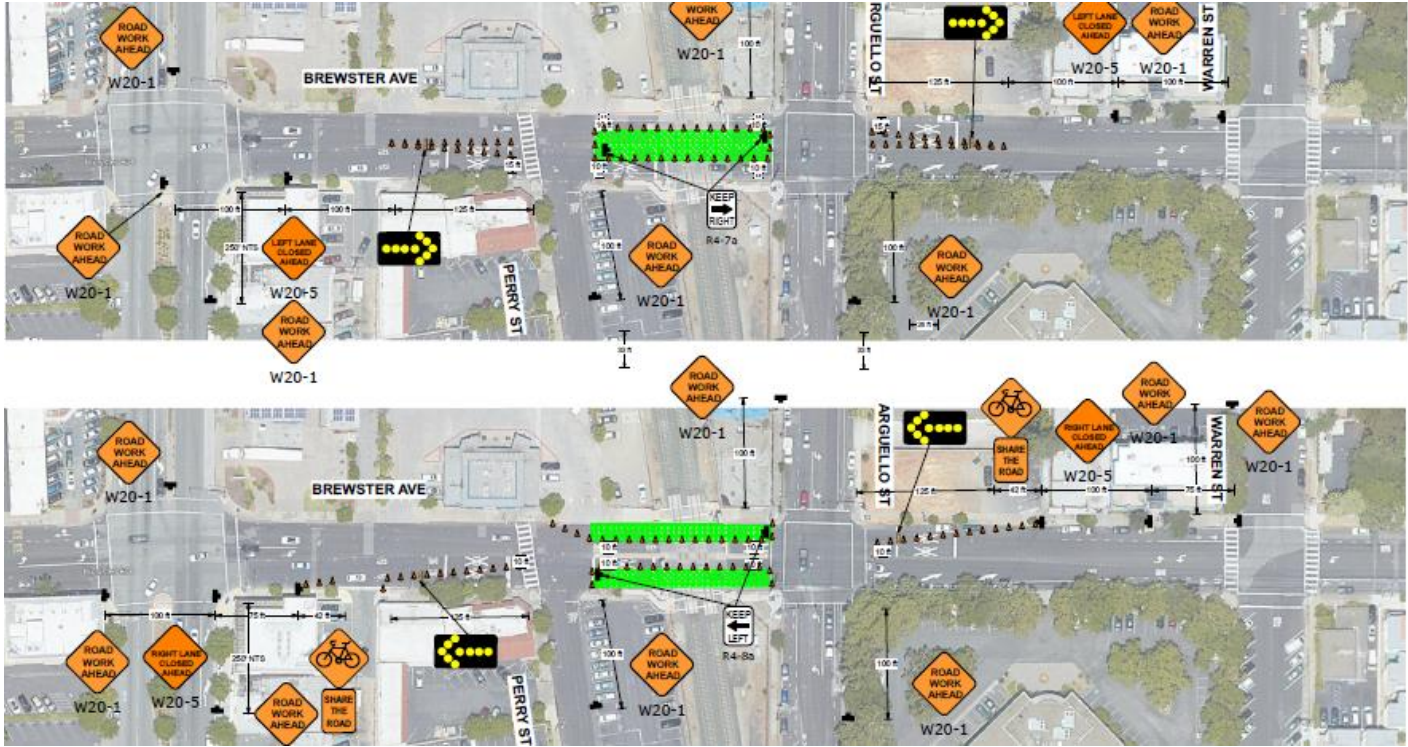



FOR MORE INFORMATION

 calmod.org

 Para traducción llama al 1.800.660.4287
如需翻譯,請電 1.800.660.4287
Cần dịch thuật, xin gọi 1.800.660.4287

CONTACT

MAIL: 2121 S. El Camino Real, Suite 300
San Mateo, CA 94403

 650.399.9659
 calmod@caltrain.com

